

SHELL MILL ADAPTERS (STANDARD)

JIS B6339

TAPER ACCURACY
AT3

G VALUE
6.3

RPM
15000

COOLANT SYSTEM
AD, AD/B

FIG-1

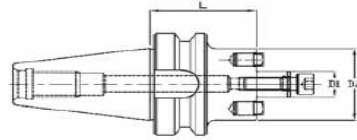
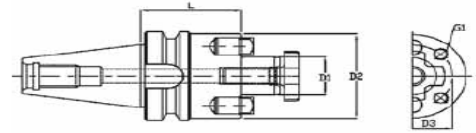

FIG-2



Catalogue No	FIG	D1	D2	D3	L	G1	Wt.Kg	Lock Screw	Wrench	Drive Key
BT30SM16035M	1	16	44		35.00		0.56	BMS1294	6 mm	BKDK16M
BT30SM22040M	1	22	50		40.00		0.7	BMS1234	8 mm	BKDK22M
BT30SM27045M	2	27	60		45.00		0.98	10010120025	10 mm	BKDK27M
BT30SM050118	2	½	1.44		1.18		2.1	BKLS05	3/16	BKDK04
BT30SM075118	2	¾	1.69		1.18		2.3	BKLS07	1/4	BKDK05
BT30SM100177	2	1	2.19		1.77		2.48	BKLS10	5/16	BKDK06
BT40SM16050M	1	16	44		50.00		1.3	BMS1294	6 mm	BKDK16M
BT40SM22055M	1	22	48		55.00		1.5	BMS1234	8 mm	BKDK22M
BT40SM22100M	1	22	48		100.00		1.8	BMS1234	8 mm	BKDK22M
BT40SM27055M	2	27	60		55.00		1.5	10010120025	10 mm	BKDK27M
BT40SM27100M	2	27	60		100.00		2.9	10010120025	10 mm	BKDK27M
BT40SM32060M	2	32	78		60.00		2.2	BKLSS32M	14 mm	BKDK32M
BT40SM32100M	2	32	78		100.00		3.1	BKLSS32M	14 mm	BKDK32M
BT40SM40060M	2	40	89.3		60.00	M12-1.756H	3.6	BKLSS40M	17 mm	BKDK40M
BT40SM40100M	2	40	89.3		100.00	M12-1.756H	4	BKLSS40M	17 mm	BKDK40M
BT40SM050177		1/2	1.44		1.77		2.47	BKLS05	3/16	BKDK04
BT40SM050400		1/2	1.44		4.00		3.5	BKLS05	3/16	BKDK04
BT40SM075177		3/4	1.75		1.77		2.9	BKLS07	1/4	BKDK05
BT40SM075400		3/4	1.75		4.00		4.3	BKLS07	1/4	BKDK05
BT40SM075600		3/4	1.75		6.00		5.5	BKLS07	1/4	BKDK05
BT40SM100177		1	2.19		1.77		3.26	BKLS10	5/16	BKDK06
BT40SM100400		1	2.19		4.00		5.5	BKLS10	5/16	BKDK06
BT40SM100600		1	2.19		6.00		7.6	BKLS10	5/16	BKDK06
BT40SM125236		1.25	2.88		2.36		4.82	BKLS12	5/16	BKDK08
BT40SM125500		1.25	2.75		5.00		7.8	BKLS12	5/16	BKDK08
BT40SM150236		1.5	3.82		2.36		4.63	BKLS15	3/8	BKSA62PKG
BT50SM16045M	1	16	44		45		3.6	BMS1294	6 mm	BKDK16M
BT50SM22045M	1	22	49		45		3.8	BMS1234	8 mm	BKDK22M
BT50SM22100M	1	22	49		100		4.5	BMS1234	8 mm	BKDK22M
BT50SM22150M	1	22	49		150		5.31	BMS1234	8 mm	BKDK22M
BT50SM22160M	1	22	49		160		4.6	BMS1234	8 mm	BKDK22M
BT50SM27045M	2	27	60		45		3.8	10010120025	10 mm	BKDK27M
BT50SM27060M	2	27	60		60		3.95	10010120025	10 mm	BKDK27M
BT50SM27100M	2	27	60		100		5.12	10010120025	10 mm	BKDK27M
BT50SM27150M	2	27	60		150		6.01	10010120025	10 mm	BKDK27M
BT50SM32045M	2	32	78		45		4	BKLSS32M	14 mm	BKDK32M
BT50SM32100M	2	32	78		100		5.6	BKLSS32M	14 mm	BKDK32M
BT50SM32150M	2	32	78		150		8	BKLSS32M	14 mm	BKDK32M
BT50SM40050M	2	40	89	66.7	50	M12-1.756H	4.5	BKLSS40M	17 mm	BKDK40M
BT50SM40100M	2	40	89	66.7	100	M12-1.756H	6.7	BKLSS40M	17 mm	BKDK40M
BT50SM40150M	2	40	89	66.7	150	M12-1.756H	9.4	BKLSS40M	17 mm	BKDK40M
BT50SM60090M	2	60	129	101.6	90	M16-2.006H	8.5	BMS1242	14 mm	BKDK60M
BT50SM050177	1	½	1.44		1.77		7.94	BKLSS05	3/16	BKDK04
BT50SM050400	1	½	1.44		4		8.92	BKLSS05	3/16	BKDK04
BT50SM075177	1	¾	1.75		1.77		8.08	BKLSS07	1/4	BKDK05
BT50SM075400	1	¾	1.75		4		9.56	BKLSS07	1/4	BKDK05
BT50SM100177	1	1	2.19		1.77		8.3	BKLSS10	5/16	BKDK06
BT50SM100400	1	1	2.4		4		11.06	BKLSS10	5/16	BKDK06
BT50SM125177	1	1.25	2.88		1.77		8.54	BKLSS12	5/16	BKDK08
BT50SM125400	1	1.25	2.88		4		12.8	BKLSS12	5/16	BKDK08
BT50SM150177	1	1.5	3.81		1.77		9.4	BKLSS15	3/8	BKDK10
BT50SM150400	1	1.5	3.81		4		16.6	BKLSS15	3/8	BKDK10
BT50SM200236	1	2	4.13		2.36		14.07	BLKSS20	9/16	BKDK12
BT50SM200400	2	2	4.88	4	4	5/8-11 UNC	19.32	BKLSS20	9/16	BKDK12
BT50SM250236	2	2.5	4.88	4	2.36	5/8-11 UNC	14.3	S388	½	BKDK16
BT50SM250400	2	2.5	4.88	4	4	5/8-11 UNC	20.2	S388	½	BKDK16

Dynamically Balanced at : G6.3@15,000 RPM
 Order Example : BT40SM27100M
 Dynamically balanced on Request
 G2.5@20,000 RPM
 Order Example : BT40SM27100MG2.5

Scope of Supply : Basic Tool Holder, Drive Key, Lockscrew
 Accessories : To be ordered separately
 Pull Stud : Page No.
 All details are subject to change without Notice

SHELL MILL ADAPTERS (STANDARD)

DIN 69893

TAPER ACCURACY
AT3

G VALUE
6.3

RPM
15000

COOLANT SYSTEM
AD



FIG-1

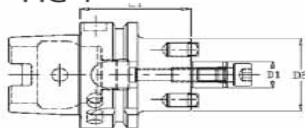
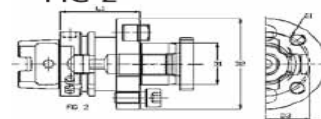

FIG-2



Catalogue No	FIG	D1	D2	D3	L	G1	Wt.Kg	Lock Screw	Wrench	Drive Key
HSK50ASM16050M	1	16	44		50		0.8	BMS1294	6 mm	BKDK16M
HSK50ASM22060M	1	22	50		60		0.9	BMS1234	8 mm	BKDK22M
HSK50ASM27060M	2	27	60		60		1.1	10010120025	10 mm	BKDK27M
HSK50ASM050200	2	1/2	1.44		2		1.17	BKLSS05	3/16	BKDK04
HSK50ASM075200	2	3/4	1.75		2		1.41	BKLSS07	1/4	BKDK05
HSK50ASM100225	2	1	2.36		2.25		1.94	BKLSS10	5/16	BKDK06
HSK63ASM16050M	1	16	44		50		1	BMS1294	6 mm	BKDK16M
HSK63ASM22050M	1	22	48		50		1.1	BMS1234	8 mm	BKDK22M
HSK63ASM27060M	2	27	60		60		1.5	10010120025	10 mm	BKDK27M
HSK63ASM32060M	2	32	78		60		1.78	BKLSS32M	14 mm	BKDK32M
HSK63ASM40060M	2	40	89	66.7	60	M12-1.75 6H	2.09	BKLSS40M	17 mm	BKDK40M
HSK63ASM050200	2	1/2	1.75	NA	2		2.11	BKLS05	3/16	BKDK04
HSK63ASM075200	2	3/4	1.75	NA	2		2.18	BKLS07	1/4	BKDK05
HSK63ASM100225	2	1	2.19	NA	2.25		2.87	BKLS10	5/16	BKDK06
HSK63ASM125225	2	1 1/4	2.88	NA	2.25		3.68	BKLS12	5/16	BKDK08
HSK63ASM150225	2	1 1/2	3.81	NA	2.25		4.49	BKLS15	3/8	BKDK10
HSK100ASM22050M	1	22	48		50		2.38	BMS1234	8 mm	BKDK22M
HSK100ASM27050M	2	27	60		50		2.58	10010120025	10 mm	BKDK27M
HSK100ASM32050M	2	32	78		50		2.98	BKLSS32M	14 mm	BKDK32M
HSK100ASM40060M	2	40	89	66.7	60	M12-1.75 6H	3.72	BKLSS40M	17 mm	BKDK40M
HSK100ASM50070M	2	50	98		70		4.81	BKLSS0MPKG	BSMW50M	BKDK50M
HSK100ASM60070M	2	60	129	101.6	70	M16-2.0 6H	5.75			BKDK60M
HSK100ASM075225	2	3/4	1.75		2.25		5.25	BKLSS07	1/4	BKDK05
HSK100ASM100225	2	1	2.19		2.25		5.81	BKLSS10	5/16	BKDK06
HSK100ASM125250	2	1 1/4	2.88		2.5		7.34	BKLSS12	5/16	BKDK08
HSK100ASM150250	2	1 1/2	3.81		2.5		9	BKLSS15	3/8	BKDK10
HSK100ASM200250	2	2	4.88	4	2.5	5/8-11 UNC	10.9	BKLSS20	9/16	BKDK12
HSK100ASM250250	2	2 1/2	4.88	4	2.5	5/8-11 UNC	11.1	BKLSS25	1/2	BKDK16

Dynamically Balanced at : G6.3@15,000 RPM
 Order Example : HSK50ASM27060M
 Dynamically balanced on Request
 G2.5@20,000 RPM
 Order Example : HSK50ASM27060MG2.5

Scope of Supply : Basic Tool Holder, Drive Key, Lockscrew
 Accessories : To be ordered separately
 Pull Stud : Page No.
 All details are subject to change without Notice

SHELL MILL ADAPTERS (STANDARD)

DIN 69871

TAPER ACCURACY
AT3

G VALUE
6.3

RPM
15000

COOLANT SYSTEM
AD , AD/B



FIG-1

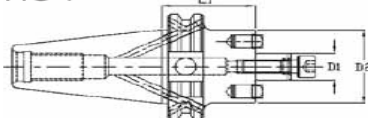
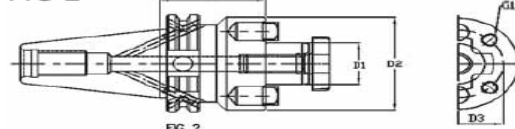

FIG-2



Catalogue No	FIG	D1	D2	D3	L1	G1	Wt. Kg.	Lock Screw	Wrench	Drive Key
--------------	-----	----	----	----	----	----	---------	------------	--------	-----------

DV40SM16035M	1	16	44.5		35		1	BMS1294	6 mm	BKDK16M
DV40SM22035M	1	22	44.5		35		1.1	BMS1234	8 mm	BKDK22M
DV40SM22100M	1	22	50		100		1.4	BMS1234	8 mm	BKDK22M
DV40SM27035M	2	27	50		35		1.2	BKLSS27M	BSMW27M	BKDK27M
DV40SM27100M	2	27	50		100		1.6	BKLSS27M	BSMW27M	BKDK27M
DV40SM32050M	2	32	78		50		1.9	BKLSS32M	BSMW32M	BKDK32M
DV40SM32100M	2	32	78		100		2.5	BKLSS32M	BSMW32M	BKDK32M
DV40SM40050M	2	40	89	66.7	50	M12-1.756H	2.2	BKLSS40M	BSMW40M	BKDK40M
DV40SM40100M	2	40	89	66.7	100	M12-1.756H	2.5	BKLSS40M	BSMW40M	BKDK40M
DV40BSM22035M	1	22	44		35		1.06	BMS1499	8 mm	BKDK22M
DV40BSM22100M	1	22	49		100		1.88	BMS1234	8 mm	BKDK22M
DV40BSM27035M	2	27	50		35		1.17	BKLSS27M	BSMW27M	BKDK27M
DV40BSM27100M	2	27	60		100		2.52	BKLSS27M	BSMW27M	BKDK27M
DV40BSM32050M	2	32	78		50		1.75	BKLSS32M	BSMW32M	BKDK32M
DV40BSM32100M	2	32	78		100		2.72	BKLSS32M	BSMW32M	BKDK32M
DV40BSM40050M	2	40	89	66.7	50	M12-1.756H	2.03	BKLSS40M	BSMW40M	BKDK40M
DV40BSM40100M	2	40	89	66.7	100	M12-1.756H	3.28	BKLSS40M	BSMW40M	BKDK40M
DV50SM16035M	1	16	44		35		2.7	BMS1294	6 mm	BKDK16M
DV50SM22035M	1	22	49		35		2.81	BMS1234	8 mm	BKDK22M
DV50SM22100M	1	22	49		100		3.72	BMS1234	8 mm	BKDK22M
DV50SM22150M	1	22	49		150		4.56	BMS1234	8 mm	BKDK22M
DV50SM27035M	2	27	60		35		2.99	BKLSS27M	BSMW27M	BKDK27M
DV50SM27100M	2	27	60		100		4.38	BKLSS27M	BSMW27M	BKDK27M
DV50SM27150M	2	27	60		150		5.46	BKLSS27M	BSMW27M	BKDK27M
DV50SM32035M	2	32	70		35		3.2	BKLSS32M	BSMW32M	BKDK32M
DV50SM32100M	2	32	78		100		5.2	BKLSS32M	BSMW32M	BKDK32M
DV50SM32150M	2	32	78		150		6.68	BKLSS32M	BSMW32M	BKDK32M
DV50SM40050M	2	40	89	66.7	50	M12-1.756H	4.02	BKLSS40M	BSMW40M	BKDK40M
DV50SM40100M	2	40	89	66.7	100	M12-1.756H	5.78	BKLSS40M	BSMW40M	BKDK40M
DV50SM40150M	2	40	89	66.7	150	M12-1.756H	7.1	BKLSS40M	BSMW40M	BKDK40M
DV50SM60070M	2	60	129	102	70	M16-2.06H	6.24	MS1242		BKDK60M
Dynamically Balanced at : G6.3@15,000 RPM Order Example : DV50SM27035M Dynamically balanced on Request G2.5@20,000 RPM Order Example : DV50SM27035MG2.5					Scope of Supply : Basic Tool Holder, Drive Key, Lockscrew Accessories : To be ordered seperately Pull Stud : Page No. All details are subject to change without Notice					

SHELL MILL ADAPTERS (STANDARD)

ANSI B5.5

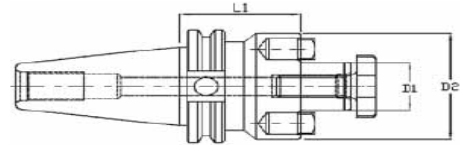
TAPER ACCURACY
AT3G VALUE
6.3RPM
15000COOLANT SYSTEM
AD , AD/B

Catalogue No	D1	D2	D 4	L	G	Wt Lbs	Lock	Allen	Drive	
							Screw	Key	Key	
CV40SM050350	1/2	1.44		3.5		3.12	BKLSS05	3/16	BKDK04	
CV40SM075138	3/4	1.75		1.38		2.21	BKLSS07	3/16	BKDK05	
CV40SM075350	3/4	1.75		3.5		3.8	BKLSS07	1/4	BKDK05	
CV40SM075600	3/4	1.75		6		5.4	BKLSS07	1/4	BKDK05	
CV40ZSM100100	1	2.19		1		2.8	BKLSS10	1/4	BKDK06	
CV40SM100206	1	2.19		2.06		3.1	BKLSS10	5/16	BKDK06	
CV40SM100400	1	2.19		4		4.3	BKLSS10	5/16	BKDK06	
CV40SM100600	1	2.19		6		5.9	BKLSS10	5/16	BKDK06	
CV40SM125212	1 1/4	2.75		2.12		4	BKLSS12	5/16	BKDK08	
CV40SM125400	1 1/4	2.75		4		5	BKLSS12	5/16	BKDK08	
CV40SM150241	1 1/2	3.38		2.41		5.01	BKLSS15	5/16	BKDK10	
CV40SM150400	1 1/2	3.38		4		6.15	BKLSS15	3/8	BKDK10	
								3/8		
CV50SM050150	1/2	2.75		1.5		6.82	BKLSS05	3/16	BKDK04	
CV50SM050350	1/2	1.44		3.5		7.54	BKLSS05	3/16	BKDK04	
CV50SM050550	1/2	1.44		5.5		8.64	BKLSS05	3/16	BKDK04	
CV50SM075150	3/4	2.75		1.5		6.88	BKLSS07	1/4	BKDK05	
CV50SM075350	3/4	1.75		3.5		8.34	BKLSS07	1/4	BKDK05	
CV50SM075550	3/4	1.75		5.5		9.7	BKLSS07	1/4	BKDK05	
CV50SM075700	3/4	1.75		7		11	BKLSS07	1/4	BKDK05	

CV50SM075900	¾	1.75		9		12.43	BKLSS07	¼	BKDK05
CV50SM100200	1	2.19		2		7.37	BKLSS10	5/16	BKDK06
CV50SM100400	1	2.4		4		9.97	BKLSS10	5/16	BKDK06
CV50SM100600	1	2.4		6		12.46	BKLSS10	5/16	BKDK06
CV50SM100800	1	2.19		8		14.03	BKLSS10	5/16	BKDK06
CV50SM1001000	1	2.19		10		17.12	BKLSS10	5/16	BKDK06
CV50SM125150	1 1/4	2.75		1.5		7.18	BKLSS12	5/16	BKDK08
CV50SM125350	1 1/4	2.75		3.5		10.31	BKLSS12	5/16	BKDK08
CV50SM125550	1 1/4	2.75		5.5		13.45	BKLSS12	5/16	BKDK08
CV50SM125700	1 1/4	2.75		7		15.68	BKLSS12	5/16	BKDK08
CV50SM125900	1 1/4	2.75		9		18.77	BKLSS12	5/16	BKDK08
CV50SM150240	1 1/2	3.38		2.4		9.71	BKLSS15	3/8	BKDK10
CV50SM150400	1 1/2	3.38		4		12.27	BKLSS15	3/8	BKDK10
CV50SM150600	1 1/2	3.38		6		15.27	BKLSS15	3/8	BKDK10
CV50SM150800	1 1/2	3.38		8		18.29	BKLSS15	3/8	BKDK10
CV50SM200240	2	4.88	4	2.4	5/8-11UNC	12.07	BKLSS20	9/16	BKDK12
CV50SM200400	2	4.88	4	4	5/8-11UNC	15.07	BKLSS20	9/16	BKDK12
CV50SM200600	2	4.88	4	6	5/8-11UNC	18.07	BKLSS20	9/16	BKDK12
CV50SM200800	2	4.88	4	8	5/8-11UNC	22.3	BKLSS20	9/16	BKDK12
CV50SM250240	2 1/2	4.88	4	2.4	5/8-11UNC	12.49		½	BKDK16
CV50SM250400	2 1/2	4.88	4	4	5/8-11UNC	16.24		½	BKDK16

Dynamically Balanced at : G6.3@15,000 RPM
Order Example : CV40SM075600
Dynamically balanced on Request
G2.5@20,000 RPM
Order Example : CV40SM075600G2.5

Scope of Supply : Basic Tool Holder, Drive Key, Lockscrew
Accessories : To be ordered separately
Pull Stud : Page No.
All details are subject to change without Notice