

HYDRAULIC CHUCKS

JIS B6339

G VALUE
2.5

RPM
20000

COOLANT SYSTEM
AD, AD/B

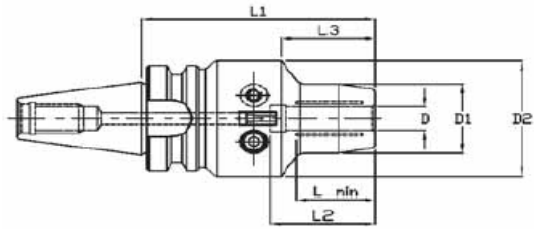

Catalogue No.	D	D1	D2	L1	L2	L3	L Min.	Pressure Screw	Stop Screw	Wt. Kg.
BT30SHYD06075MO	6	26	49	75	38	24	23	HYDC-1010	CSS-0510M	0.59
BT30SHYD08075MO	8	28	49	75	38	24	24	HYDC-1010	CSS-0510M	0.61
BT30SHYD10080MO	10	30	49	80	40	26	30	HYDC-1010	CSS-0612M	0.65
BT30SHYD12085MO	12	32	49	85	45	40	36	HYDC-1010	CSS-0615M	0.69
BT30SHYD14100MO	14	34	49	100	45	40	40	HYDC-1010	CSS-0812M	1
BT30SHYD16100MO	16	38	49	100	50	46	40	HYDC-1010	CSS-0812M	1.06
BT30SHYD18100MO	18	40	49	100	52	50	43	HYDC-1010	CSS-0815M	1.09
BT30SHYD20100MO	20	42	49	100	52	50	43	HYDC-1010	CSS-0815M	1.11
BT30SHYD025295O	¼	26	49	2.95"	38	24	23	HYDC-1010	CSS-0510M	1.3
BT30SHYD038315O	3/8	30	49	3.15"	40	26	30	HYDC-1010	CSS-0612M	1.43
BT30SHYD050335O	½	32	49	3.35"	45	40	36	HYDC-1010	CSS-0615M	1.5
BT30SHYD062394O	5/8	38	49	3.94"	50	46	40	HYDC-1010	CSS-0812M	2.43
BT30SHYD075413O	¾	42	49	4.13"	52	50	43	HYDC-1010	CSS-0815M	2.65
BT40SHYD06080MO	6	26	49	80	38	24	23	HYDC-1010	CSS-0510M	2.5
BT40SHYD08080MO	8	28	49	80	38	24	24	HYDC-1010	CSS-0510M	2.5
BT40SHYD10080MO	10	30	49	80	40	26	30	HYDC-1010	CSS-0612M	2.5
BT40SHYD12090MO	12	32	49	90	45	40	36	HYDC-1010	CSS-0615M	2.5
BT40SHYD14090MO	14	34	49	90	45	40	40	HYDC-1010	CSS-0812M	3
BT40SHYD16090MO	16	38	49	90	50	46	40	HYDC-1010	CSS-0812M	3
BT40SHYD18095MO	18	40	49	95	52	50	43	HYDC-1010	CSS-0815M	3
BT40SHYD25095MO	20	42	49	95	52	50	43	HYDC-1010	CSS-0815M	3
BT40SHYD25105MO	25	53		105	59		46	HYDC-1010	CSS-1015M	4
BT40SHYD32110MO	32	60		110	60		51	HYDC-1010	CSS-1015M	4
BT40SHYD025315O	¼	26	49	3.15"	38	24	23	HYDC-1010	CSS-0510M	2.87
BT40SHYD038335O	3/8	30	49	3.35"	40	26	30	HYDC-1010	CSS-0612M	3.04
BT40SHYD050354O	½	32	49	3.54"	45	40	40	HYDC-1010	CSS-0615M	3.15
BT40SHYD062354O	5/8	38	49	3.54"	50	46	40	HYDC-1010	CSS-0812M	3.24
BT40SHYD075374O	¾	42	49	3.74"	52	50	43	HYDC-1010	CSS-0815M	3.5
BT40SHYD100450O	1.0	53		4.50"	59		46	HYDC-1010	CSS-1015M	4.81
BT40SHYD125470O	1 1/4	60		4.70"	60		51	HYDC-1010	CSS-1015M	5.45
BT50SHYD06090MO	6	26	49	90	38	24	23	HYDC-1010	CSS-0510M	3
BT50SHYD08090MO	8	28	49	90	38	24	24	HYDC-1010	CSS-0510M	3
BT50SHYD10095MO	10	30	49	95	40	26	30	HYDC-1010	CSS-0612M	3
BT50SHYD12100MO	12	32	49	100	45	40	36	HYDC-1010	CSS-0615M	3
BT50SHYD14100MO	14	34	49	100	45	40	40	HYDC-1010	CSS-0812M	3
BT50SHYD16105MO	16	38	49	105	50	46	40	HYDC-1010	CSS-0812M	3
BT50SHYD18105MO	18	40	49	105	52	50	43	HYDC-1010	CSS-0815M	3
BT50SHYD20105MO	20	42	49	105	52	50	43	HYDC-1010	CSS-0815M	3
BT50SHYD25115MO	25	53	63	115	59		46	HYDC-1010	CSS-1015M	4
BT50SHYD32120MO	32	60	63	120	60		51	HYDC-1010	CSS-1015M	4
BT50SHYD40125MO	40	68		125	65		57	HYDC-1010	CSS-1020M	4.2
BT50SHYD025354O	¼"	26	49	3.54"	38	24	23	HYDC-1010	CSS-0510M	3
BT50SHYD038374O	3/8"	30	49	3.74"	40	26	30	HYDC-1010	CSS-0612M	3
BT50SHYD050394O	½"	32	49	3.94"	45	40	36	HYDC-1010	CSS-0615M	3
BT50SHYD062394O	5/8"	38	49	3.94"	50	46	40	HYDC-1010	CSS-0812M	3
BT50SHYD075413O	¾"	42	49	4.13"	52	50	43	HYDC-1010	CSS-0815M	3
BT50SHYD100453O	1.0"	53	63	4.53"	59		46	HYDC-1010	CSS-1015M	4
BT50SHYD125472O	1 ¼"	60	63	4.72"	60		51	HYDC-1010	CSS-1015M	4

Dynamically balanced to
G2.5@20,000 RPM
Order Example : BT50SHYD12100M
Pressurizing Media : Oil

Scope of Supply : Basic Tool Holder, Pressure Screw, Stopscrew, Allen Key
Accessories Viz : To be ordered separately
Reduction Sleeves : Page No.
Pull Stud : Page No.
All details are subject to change without Notice

HYDRAULIC CHUCKS

DIN 69893

TAPER ACCURACY
AT3

G VALUE
2.5

RPM
20000

COOLANT SYSTEM
AD

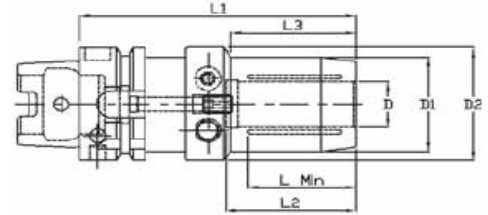

Catalogue No.	D	D1	D2	L1	L2	L3	L Min.	Pressure Screw	Stop Screw	Wt. Kg
HSK50ASHYD06080MO	6	26	49	80	38	24	23	HYDC-1010	CSS-0510M	0.8
HSK50ASHYD08080MO	8	28	49	80	38	24	24	HYDC-1010	CSS-0510M	0.9
HSK50ASHYD10085MO	10	30	49	85	40	26	30	HYDC-1010	CSS-0612M	0.9
HSK50ASHYD12090MO	12	32	49	90	45	40	36	HYDC-1010	CSS-0615M	1.3
HSK50ASHYD025325O	¼"	26	49	3.25"	38	24	23	HYDC-1010	CSS-0510M	1.8
HSK50ASHYD038338O	3/8"	30	49	3.38"	40	26	30	HYDC-1010	CSS-0612M	2
HSK50ASHYD050350O	½"	32	49	3.50"	45	40	36	HYDC-1010	CSS-0615M	2.9
HSK63ASHYD06080MO	6	26	49	80	38	24	23	HYDC-1010	CSS-0510M	1.01
HSK63ASHYD06150MO	6	26	49	150	38	24	23	HYDC-1010	CSS-0510M	1.27
HSK63ASHYD08080MO	8	28	49	80	38	24	24	HYDC-1010	CSS-0510M	1.03
HSK63ASHYD08150MO	8	28	49	150	38	24	24	HYDC-1010	CSS-0510M	1.33
HSK63ASHYD10085MO	10	30	49	85	40	26	30	HYDC-1010	CSS-0612M	1.07
HSK63ASHYD10150MO	10	30	49	150	40	26	30	HYDC-1010	CSS-0612M	1.4
HSK63ASHYD12090MO	12	32	49	90	45	40	36	HYDC-1010	CSS-0615M	1.1
HSK63ASHYD12150MO	12	32	49	150	45	40	36	HYDC-1010	CSS-0615M	1.46
HSK63ASHYD14090MO	14	34	49	90	45	40	36	HYDC-1010	CSS-0812M	1.12
HSK63ASHYD14150MO	14	34	49	150	45	40	36	HYDC-1010	CSS-0812M	1.51
HSK63ASHYD16095MO	16	38	49	95	50	46	40	HYDC-1010	CSS-0812M	1.22
HSK63ASHYD16150MO	16	38	49	150	50	46	40	HYDC-1010	CSS-0812M	1.68
HSK63ASHYD18095MO	18	40	49	95	52	50	40	HYDC-1010	CSS-0815M	1.25
HSK63ASHYD18150MO	18	40	49	150	52	50	40	HYDC-1010	CSS-0815M	1.76
HSK63ASHYD20100MO	20	42	49	100	52	50	43	HYDC-1010	CSS-0815M	1.32
HSK63ASHYD20150MO	20	42	49	150	52	50	43	HYDC-1010	CSS-0815M	1.84
HSK63ASHYD25105MO	25	53		105	59		43	HYDC-1010	CSS-1015M	2
HSK63ASHYD25120MO	25	53		120	59		43	HYDC-1010	CSS-1015M	2.25
HSK63ASHYD32125MO	32	60		125	60		46	HYDC-1010	CSS-1015M	2.28
HSK63ASHYD025325O	¼"	26	42	3.25"	38	24	23	HYDC-1010	CSS-0510M	2.2
HSK63ASHYD038338O	3/8"	30	42	3.38"	40	26	30	HYDC-1010	CSS-0612M	2.4
HSK63ASHYD050350O	½"	32	42	3.50"	45	40	36	HYDC-1010	CSS-0615M	4.4
HSK63ASHYD062375O	5/8"	38	50	3.75"	50	46	40	HYDC-1010	CSS-0812M	4.4
HSK63ASHYD075400O	¾"	42	50	4.00"	52	50	43	HYDC-1010	CSS-0815M	4.6
HSK63ASHYD025475O	1"	53		4.75"	59		43	HYDC-1010	CSS-1015M	5.1
HSK63ASHYD125500O	1¼"	60		5.00"	60		46	HYDC-1010	CSS-1015M	5.3
HSK100ASHYD06085MO	6	26	49	85	38	24	23	HYDC-1010	CSS-0510M	2.6
HSK100ASHYD06150MO	6	26	49	150	38	24	23	HYDC-1010	CSS-0510M	3
HSK100ASHYD08085MO	8	28	49	85	38	24	24	HYDC-1010	CSS-0510M	3.5
HSK100ASHYD08150MO	8	28	49	150	38	24	24	HYDC-1010	CSS-0510M	3
HSK100ASHYD10090MO	10	30	49	90	40	26	30	HYDC-1010	CSS-0612M	3.8
HSK100ASHYD10150MO	10	30	49	150	40	26	30	HYDC-1010	CSS-0612M	3
HSK100ASHYD12095MO	12	32	49	95	45	40	36	HYDC-1010	CSS-0615M	3.8
HSK100ASHYD12150MO	12	32	49	150	45	40	36	HYDC-1010	CSS-0615M	3
HSK100ASHYD14095MO	14	34	49	95	45	40	36	HYDC-1010	CSS-0812M	4
HSK100ASHYD14150MO	14	34	49	150	45	40	36	HYDC-1010	CSS-0812M	3.1
HSK100ASHYD16100MO	16	38	49	100	50	46	40	HYDC-1010	CSS-0812M	4

HSK100ASHYD16150MO	16	38	49	150	50	46	40	HYDC-1010	CSS-0812M	4.2
HSK100ASHYD18100MO	18	40	49	100	52	50	40	HYDC-1010	CSS-0815M	2.8
HSK100ASHYD18150MO	18	40	49	150	52	50	40	HYDC-1010	CSS-0815M	3.3
HSK100ASHYD20105MO	20	42	49	105	52	50	43	HYDC-1010	CSS-0815M	4.2
HSK100ASHYD20150MO	20	42	49	150	52	50	43	HYDC-1010	CSS-0815M	3.3
HSK100ASHYD25115MO	25	53		115	59		46	HYDC-1010	CSS-1015M	3.3
HSK100ASHYD25200MO	25	53		200	59		46	HYDC-1010	CSS-1015M	4.5
HSK100ASHYD32120MO	32	60		120	60		51	HYDC-1010	CSS-1015M	3.6
HSK100ASHYD32200MO	32	60		120	60		51	HYDC-1010	CSS-1015M	5.3
HSK100ASHYD025338O	¼"	26	49	3.38"	38	24	23	HYDC-1010	CSS-0510M	5.9
HSK100ASHYD038350O	3/8"	30	49	3.50"	40	26	30	HYDC-1010	CSS-0612M	5.9
HSK100ASHYD050375O	½"	32	49	3.75"	45	40	36	HYDC-1010	CSS-0615M	6
HSK100ASHYD062400O	5/8"	38	49	4.00"	50	46	40	HYDC-1010	CSS-0812M	6.2
HSK100ASHYD075425O	¾"	42	49	4.25"	52	50	43	HYDC-1010	CSS-0815M	6.4
HSK100ASHYD100475O	1"	53		4.75"	59		46	HYDC-1010	CSS-1015M	7.3
HSK100ASHYD125500O	1 ¼"	60		5.00"	60		51	HYDC-1010	CSS-1015M	8

Dynamically balanced to
G2.5@20,000 RPM
Order Example : HSK100ASHYD10090M
Pressurizing Media : Oil

Scope of Supply : Basic Tool Holder, Pressure Screw, Stopscrew, Allen Key
Accessories Viz : To be ordered seperately
Reduction Sleeves : Page No.
Pull Stud : Page No.
All details are subject to change without Notice

HYDRAULIC CHUCKS

DIN 69871

TAPER ACCURACY
AT3

G VALUE
2.5

RPM
20000

COOLANT SYSTEM
AD , AD/B

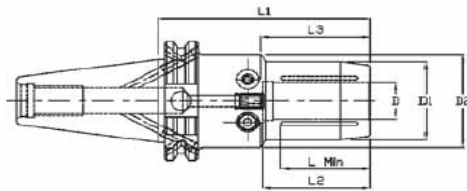

Catalogue No.	D	D1	D2	L1	L2	L3	L Min.	Pressure Screw	Stop Screw	Wt. Kg
DV40SHYD06075MO	6	26	50	75	38	24	23	HYDC-1010	CSS-0510M	2.1
DV40SHYD06150MO	6	26	50	150	38	24	23	HYDC-1010	CSS-0510M	2.4
DV40SHYD08075MO	8	28	50	75	38	24	24	HYDC-1010	CSS-0510M	2.1
DV40SHYD08150MO	8	28	50	150	38	24	24	HYDC-1010	CSS-0510M	2.4
DV40SHYD10075MO	10	30	50	75	40	26	30	HYDC-1010	CSS-0612M	2.1
DV40SHYD10150MO	10	30	50	150	40	26	30	HYDC-1010	CSS-0612M	2.43
DV40SHYD12080MO	12	32	50	80	45	40	36	HYDC-1010	CSS-0615M	2.1
DV40SHYD12150MO	12	32	50	150	45	40	36	HYDC-1010	CSS-0615M	2.43
DV40SHYD14080MO	14	34	50	80	45	40	40	HYDC-1010	CSS-0812M	2.65
DV40SHYD14150MO	14	34	50	150	45	40	40	HYDC-1010	CSS-0812M	2.83
DV40SHYD16085MO	16	38	50	85	50	46	40	HYDC-1010	CSS-0812M	2.65
DV40SHYD16150MO	16	38	50	150	50	46	40	HYDC-1010	CSS-0812M	2.83
DV40SHYD18090MO	18	40	50	90	52	50	43	HYDC-1010	CSS-0815M	2.65
DV40SHYD18150MO	18	40	50	150	52	50	43	HYDC-1010	CSS-0815M	2.83
DV40SHYD20090MO	20	42	50	90	52	50	43	HYDC-1010	CSS-0815M	2.7
DV40SHYD20150MO	20	42	50	150	52	50	43	HYDC-1010	CSS-0815M	2.87
DV40SHYD25110MO	25	53		110	59		46	HYDC-1010	CSS-1015M	2.8
DV40SHYD32115MO	32	60		115	60		51	HYDC-1010	CSS-1015M	2.83
DV40BSHYD06075MO	6	26	50	75	38	24	23	HYDC-1010	CSS-0510M	2.1
DV40BSHYD06150MO	6	26	50	150	38	24	23	HYDC-1010	CSS-0510M	2.4
DV40BSHYD08075MO	8	28	50	75	38	24	24	HYDC-1010	CSS-0510M	2.1
DV40BSHYD08150MO	8	28	50	150	38	24	24	HYDC-1010	CSS-0510M	2.4
DV40BSHYD10075MO	10	30	50	75	40	26	30	HYDC-1010	CSS-0612M	2.1
DV40BSHYD10150MO	10	30	50	150	40	26	30	HYDC-1010	CSS-0612M	2.43
DV40BSHYD12080MO	12	32	50	80	45	40	36	HYDC-1010	CSS-0615M	2.1
DV40BSHYD12150MO	12	32	50	150	45	40	36	HYDC-1010	CSS-0615M	2.43
DV40BSHYD14080MO	14	34	50	80	45	40	40	HYDC-1010	CSS-0812M	2.65
DV40BSHYD14150MO	14	34	50	150	45	40	40	HYDC-1010	CSS-0812M	2.83
DV40BSHYD16085MO	16	38	50	85	50	46	40	HYDC-1010	CSS-0812M	2.65

DV40BSHYD16150MO	16	38	50	150	50	46	40	HYDC-1010	CSS-0812M	2.83
DV40BSHYD18090MO	18	40	50	90	52	50	43	HYDC-1010	CSS-0815M	2.65
DV40BSHYD18150MO	18	40	50	150	52	50	43	HYDC-1010	CSS-0815M	2.83
DV40BSHYD20090MO	20	42	50	90	52	50	43	HYDC-1010	CSS-0815M	2.7
DV40BSHYD20150MO	20	42	50	150	52	50	43	HYDC-1010	CSS-0815M	2.87
DV40BSHYD25110MO	25	53		110	59		46	HYDC-1010	CSS-1015M	2.8
DV40BSHYD25150MO	25	53		150	59		46	HYDC-1010	CSS-1015M	2.98
DV40BSHYD32115MO	32	60		115	60		51	HYDC-1010	CSS-1015M	2.83
DV40BSHYD32150MO	32	60		150	60		51	HYDC-1010	CSS-1015M	3.05
DV50SHYD06075MO	6	26	50	75	38	24	23	HYDC-1010	CSS-0510M	2.84
DV50SHYD08075MO	8	28	50	75	38	24	24	HYDC-1010	CSS-0510M	2.86
DV50SHYD10075MO	10	30	50	75	40	26	30	HYDC-1010	CSS-0612M	2.9
DV50SHYD12080MO	12	32	50	80	45	40	36	HYDC-1010	CSS-0615M	2.89
DV50SHYD14080MO	14	34	50	80	45	40	40	HYDC-1010	CSS-0812M	2.94
DV50SHYD16085MO	16	38	50	85	50	46	40	HYDC-1010	CSS-0812M	3
DV50SHYD18090MO	18	40	50	90	52	50	43	HYDC-1010	CSS-0815M	3.03
DV50SHYD20090MO	20	42	50	90	52	50	43	HYDC-1010	CSS-0815M	3.05
DV50SHYD25100MO	25	53		100	59		46	HYDC-1010	CSS-1015M	4
DV50SHYD32100MO	32	60		100	60		51	HYDC-1010	CSS-1015M	4.2
DV50SHYD40110MO	40	68		110	65		57	HYDC-1010	CSS-1015M	4.5
DV50BSHYD06075MO	6	26	50	75	38	24	23	HYDC-1010	CSS-0510M	2.84
DV50BSHYD08075MO	8	28	50	75	38	24	24	HYDC-1010	CSS-0510M	2.86
DV50BSHYD10075MO	10	30	50	75	40	26	30	HYDC-1010	CSS-0612M	2.9
DV50BSHYD12080MO	12	32	50	80	45	40	36	HYDC-1010	CSS-0615M	2.89
DV50BSHYD14080MO	14	34	50	80	45	40	40	HYDC-1010	CSS-0812M	2.94
DV50BSHYD16085MO	16	38	50	85	50	46	40	HYDC-1010	CSS-0812M	3
DV50BSHYD18090MO	18	40	50	90	52	50	43	HYDC-1010	CSS-0815M	3.03
DV50BSHYD20090MO	20	42	50	90	52	50	43	HYDC-1010	CSS-0815M	3.05
DV50BSHYD25100MO	25	53		100	59		46	HYDC-1010	CSS-1015M	4
DV50BSHYD32100MO	32	60		100	60		51	HYDC-1010	CSS-1015M	4.2
DV50BSHYD40110MO	40	68		110	65		57	HYDC-1010	CSS-1015M	4.5

Dynamically balanced to
G2.5@20,000 RPM
Order Example : DV50SHYD08075M
Pressurizing Media : Oil

Scope of Supply : Basic Tool Holder, Pressure Screw, Stopscrew, Allen Key
Accessories Viz : To be ordered seperately
Reduction Sleeves : Page No.
Pull Stud : Page No.
All details are subject to change without Notice

HYDRAULIC CHUCKS

ANSI B5.5

TAPER ACCURACY
AT3

G VALUE
2.5

RPM
20000

COOLANT SYSTEM
AD , AD/B

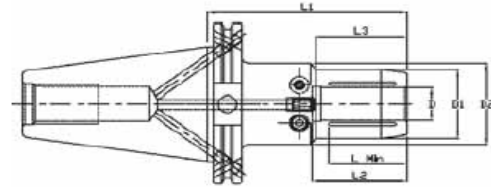

Catalogue No.	D	D1	D2	L1	L2	L3	L Min.	Pressure Screw	Stop Screw	Wt. Kg
CV40SHYD06075MO	6	26	50	75	38	24	23	SHYDC-0717	CSS-0510M	1.25
CV40SHYD06150MO	6	26	50	150	38	24	23	SHYDC-0717	CSS-0510M	1.49
CV40SHYD08075MO	8	28	50	75	38	24	24	SHYDC-0717	CSS-0510M	1.27
CV40SHYD08150MO	8	28	50	150	38	24	24	SHYDC-0717	CSS-0510M	1.55
CV40SHYD10075MO	10	30	50	75	40	26	30	SHYDC-0717	CSS-0612M	1.32
CV40SHYD10150MO	10	30	50	150	40	26	30	SHYDC-0717	CSS-0612M	1.62
CV40SHYD12080MO	12	32	50	80	45	40	36	SHYDC-0717	CSS-0615M	1.32
CV40SHYD12150MO	12	32	50	150	45	40	36	SHYDC-0717	CSS-0615M	1.67
CV40SHYD14080MO	14	34	50	80	45	40	40	SHYDC-0717	CSS-0812M	1.47
CV40SHYD14150MO	14	34	50	150	45	40	40	SHYDC-0717	CSS-0812M	1.77
CV40SHYD16085MO	16	38	50	85	50	46	40	SHYDC-0717	CSS-0812M	1.54
CV40SHYD16150MO	16	38	50	150	50	46	40	SHYDC-0717	CSS-0812M	1.95
CV40SHYD18090MO	18	40	50	90	52	50	43	SHYDC-0717	CSS-0815M	1.56

