

## FacePlate Drawbar Operated(Standard Length)

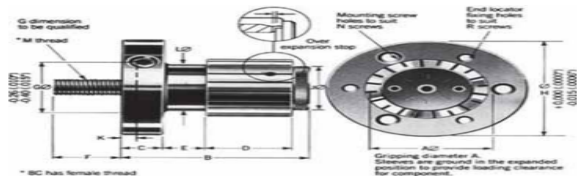

Model	A Min	A Max	B	C	D	E	F	G	H	J	K	L	M	N DP	N $\tilde{A}$	O DP	O $\tilde{A}$	Catalogue No.
3A	12,5	16,0	60	20,0	22,0	14,6	20	40	75	11,0	6	12,6	M4	58	M8	28,0	M4	90.800.210.1
2C	16,0	22,0	66	20,0	27,0	15,6	22	40	75	15,0	6	14,1	M8	58	M8	28,0	M4	90.800.215.1
1C	22,0	28,0	72	20,0	32,0	15,5	30	40	75	20,0	6	20,7	M8	58	M8	58	M6	90.800.221.1
18C	28,0	41,0	79	20,0	38,0	15,3	31	40	75	26,5	6	26,3	M10	58	M8	58	M6	90.800.227.1
4C	41,0	63,5	84	20,0	43,0	14,8	36	40	75	37,5	6	36,0	M12	58	M8	58	M6	90.800.234.1
5C	63,5	76,2	109	25,0	51,0	25,3	36	60	120	55,0	6	57,3	M20	94	M10	94	M8	90.800.241.1
6C	76,2	89,0	118	25,0	57,0	24,7	37	60	120	74,5	6	71,1	M20	94	M10	94	M8	90.800.248.1
7C	89,0	130,0	133	30,0	63,5	25,2	47	100	180	86,5	6	84,1	M24	150	M12	150	M10	90.800.253.1
8C	130,0	178,0	153	30,0	79,0	24,6	22	100	180	124,5	6	123,0	M36	150	M12	150	M10	90.800.259.1

## Spigot Drawbar Operated

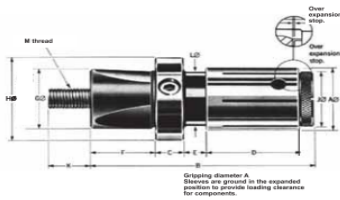

Model	A Min	A Max	B	C	D	E	F	G	H	J	K	L	M	Catalogue No.
3A	12,5	16,0	60	11,0	22	9,8	20	20	26	11,0	14	9,5	M4	90.810.210.1
2C	16,0	22,0	70	11,0	27	8,0	20	20	26	15,0	18	14,1	M8	90.810.215.1
1C	22,0	28,0	85	11,0	32	10,0	27	30	40	20,0	17	20,7	M8	90.820.221.1
18C	28,0	41,0	92	11,0	38	10,5	27	30	40	26,3	18	26,3	M10	90.820.227.1
4C	41,0	63,5	99	13,0	43	9,5	27	30	50	37,0	21	37,0	M12	90.820.234.1

## Between Center (Standard Length)

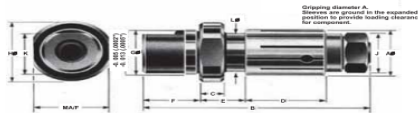

Model	A Min	A Max	B	C	D	E	F	G	H	J A/F	K	L	M	Catalogue No.
3A	12,5	16,0	77	11,0	22,0	21,0	20	20	26,0	10	18	9,5	22	90.811.110.1
2C	16,0	22,0	83	11,0	27,0	20,0	20	20	26,0	13	18	14,1	22	90.811.115.1
1C	22,0	28,0	99	11,0	32,0	21,5	27	30	40,0	19	27	20,7	36	90.821.121.1
18C	28,0	41,0	107	11,0	38,0	21,2	27	30	40,0	24	27	26,3	36	90.821.127.1
4C	41,0	63,5	120	13,0	43,0	23,0	27	30	50,0	36	27	37,0	46	90.821.134.1
5C	63,5	76,2	145	--	51,0	26,0	35	40	57,3	55	35	57,3	50	90.831.141.1
6C	76,2	89,0	155	--	57,0	26,3	35	50	71,1	65	45	71,1	60	90.841.148.1
7C	89,0	130,0	205	--	63,5	44,0	50	60	48,1	85	55	84,1	70	90.851.153.1
8C	130,0	178,0	235	--	89,5	55,5	50	80	123,0	124	73	123,1	105	90.861.159.1

## Modular Expanding Mandrel Nut Operated Face Plate(Standard Length)

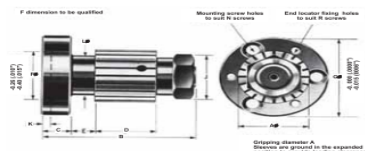

Model	A Min	A Max	B	C	D	E	F	G	J A/F	K	L	N DP	$\phi$	O DP	$\phi$	Catalogue No.
3A	12,5	16,0	73	20,0	22,0	15,0	40	75	10	6	12,6	58	M8	28	M4	90.800.110.1
2C	16,0	22,0	79	20,0	27,0	15,0	40	75	13	6	14,1	58	M8	28	M4	90.800.115.1
1C	22,0	28,5	86	20,0	32,0	15,5	40	75	19	6	20,7	58	M8	58	M6	90.800.121.1
18C	28,0	41,0	94	20,0	38,0	15,2	40	75	24	6	26,3	58	M8	58	M6	90.800.127.1

4C	41,0	63,5	105	20,0	43,0	15,0	40	75	36	6	37,0	58	M8	58	M6	90.800.134.1
5C	63,5	76,2	134	25,0	51,0	25,0	60	120	55	6	57,3	94	M10	94	M8	90.800.141.1
6C	76,2	89,0	144	25,0	57,0	25,0	60	120	65	6	71,1	94	M10	94	M8	90.800.148.1
7C	89,0	130,0	166	30,0	63,5	25,0	100	180	85A	6	84,1	150	M12	150	M10	90.800.153.1
8C	130,0	178,0	185	30,0	79,5	25,0	100	180	124A	6	123,0	150	M12	150	M10	90.800.159.1

## Cantilever Operated

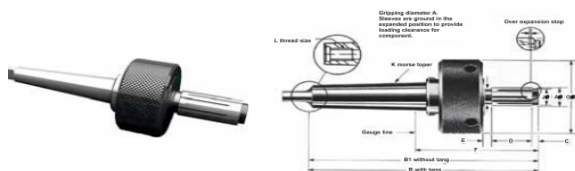

Model	A Min	A Max	B	B1	C	D	E	F	G	H	J	K	L	*Catalogue No. 1	*Catalogue No. 2
3A	12,5	16,0	141,0	127,0	3,2	22,0	4,0	66,0	48	9,5	11	2	M10	90.592.510.1	90.582.510.1
2C	16,0	22,0	155,0	141,0	4,0	27,0	10,0	80,0	50	14,1	15	2	M10	90.592.515.1	90.582.515.1
1C	22,0	28,5	189,0	171,0	5,0	32,0	14,0	95,0	60	20,6	20	3	M10	90.593.521.1	90.583.521.1
18C	28,0	41,0	202,5	184,0	5,5	38,0	15,0	108,0	70	26,3	27	3	M12	90.593.527.1	90.583.527.1
4C	41,0	63,5	246,5	224,0	6,0	43,0	25,5	129,0	90	37,0	37	4	M16	90.594.534.1	90.584.534.1
5C	63,5	76,2	260,0	238,0	8,0	51,0	24,5	142,5	100	57,3	55	4	M16	90.594.541.1	90.584.541.1
6C	76,2	89,0	320,0	292,0	11,0	57,0	23,5	170,5	110	71,1	75	5	M20	90.595.548.1	90.585.548.1
7C	89,0	130,0	323,0	295,0	14,0	63,5	27,0	173,5	130	84,1	86	5	M20	90.595.553.1	90.585.553.1

## Standard type sleeve

Standard Type Sleeve



Standard Type Sleeve

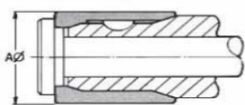

Model	A Min	A Max	Length	Catalogue No.
3A1	12m5	16,0	22,0	92.000.20.x.x.xxx
2C1	16,0	22,0	27,0	92.050.20.x.x.xxx
1C1	22,0	28,5	32,0	92.100.20.x.x.xxx
18C1	28,5	41,0	38,0	92.150.20.x.x.xxx
4C1	41,0	63,5	43,0	92.200.20.x.x.xxx
5C1	63,5	76,0	51,0	92.250.20.x.x.xxx
6C1	76,0	89,0	57,0	92.300.20.x.x.xxx
*7C1	89,0	130,0	63,5	92.350.20.x.x.xxx
*8C1		178,0	80,0	92.400.20.x.x.xxx

## Flush Type Sleeve



Flush Type Sleeve

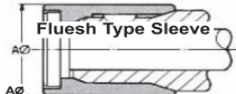

Model	A Min	A Max	Length	Catalogue No.
3A1	12m5	16,0	22,0	92.000.20.x.x.xxx
2C1	16,0	22,0	27,0	92.050.20.x.x.xxx
1C1	22,0	28,5	32,0	92.100.20.x.x.xxx
18C1	28,5	41,0	38,0	92.150.20.x.x.xxx
4C1	41,0	63,5	43,0	92.200.20.x.x.xxx
5C1	63,5	76,0	51,0	92.250.20.x.x.xxx
6C1	76,0	89,0	57,0	92.300.20.x.x.xxx
*7C1	89,0	130,0	63,5	92.350.20.x.x.xxx
*8C1		178,0	80,0	92.400.20.x.x.xxx