

END MILL HOLDERS

JIS B6339

TAPER ACCURACY
AT3

G VALUE
6.3

RPM
15000

COOLANT SYSTEM
AD , AD/B

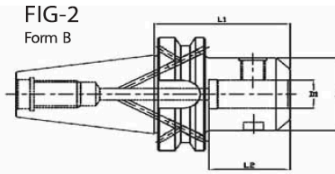
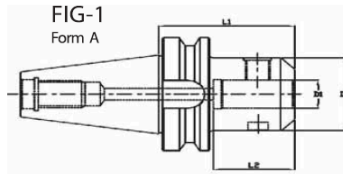

| Catalogue No | Fig | D1 | D2 | L1 | L2 | Wt.Kg | Clamping Screw | No of Clamp Scr | Wrench |
|---------------|-----|-------|-------|--------|-------|-------|----------------|-----------------|--------|
| BT30EM06050M | 1 | 6.00 | 25.00 | 50.00 | 40.00 | 0.50 | BSS0M012 | 1 | 3 mm |
| BT30EM08060M | 1 | 8.00 | 28.00 | 60.00 | 40.00 | 0.60 | BSS0M014 | 1 | 4 mm |
| BT30EM10060M | 1 | 10.00 | 35.00 | 60.00 | 45.00 | 0.70 | BSS0M018 | 1 | 5 mm |
| BT30EM12060M | 1 | 12.00 | 42.00 | 60.00 | 50.00 | 0.80 | BSS0M023 | 1 | 6 mm |
| BT30EM16060M | 1 | 16.00 | 48.00 | 60.00 | 53.00 | 2.80 | BSS0M025 | 1 | 6 mm |
| BT30EM20080M | 1 | 20.00 | 52.00 | 80.00 | 55.00 | 1.12 | BSS0M026 | 1 | 8 mm |
| BT30EM012236 | 1 | 1/8 | 0.69 | 2.36 | 3.30 | 0.94 | BS1045PKG | 1 | 3/32 |
| BT30EM018236 | 1 | 3/16 | 0.69 | 2.36 | 3.30 | 0.94 | BS1045PKG | 1 | 3/32 |
| BT30EM025236 | 1 | 1/4 | 1.00 | 2.36 | 3.30 | 1.10 | BELS025025PKG | 1 | 1/8 |
| BT30EM031236 | 1 | 5/16 | 1.00 | 2.36 | 3.30 | 1.08 | BELS031031PKG | 1 | 5/32 |
| BT30EM038236 | 1 | 3/8 | 1.00 | 2.36 | 3.30 | 1.08 | BELS038031PKG | 1 | 3/16 |
| BT30EM050236 | 1 | 1/2 | 1.38 | 2.36 | 1.97 | 1.26 | BELS044038PKG | 1 | 7/32 |
| BT30EM062236 | 1 | 5/8 | 1.63 | 2.36 | 2.09 | 1.42 | BELS056050PKG | 1 | 1/4 |
| | | | | | | | | | |
| BT40EM06050M | 1 | 6.00 | 25.00 | 50.00 | 40.00 | 1.00 | BSS03M012 | 1 | 3 mm |
| BT40EM08050M | 1 | 8.00 | 28.00 | 50.00 | 40.00 | 1.04 | BSS03M014 | 1 | 4 mm |
| BT40EM10063M | 1 | 10.00 | 35.00 | 63.00 | 45.00 | 1.17 | BSS03M018 | 1 | 5 mm |
| BT40EM12063M | 1 | 12.00 | 42.00 | 63.00 | 50.00 | 1.26 | BSS03M023 | 1 | 6 mm |
| BT40EM14063M | 1 | 14.00 | 44.00 | 63.00 | 50.00 | 1.29 | BSS03M023 | 1 | 6 mm |
| BT40EM16063M | 1 | 16.00 | 48.00 | 63.00 | 53.00 | 1.34 | BSS03M025 | 1 | 6 mm |
| BT40EM18063M | 1 | 18.00 | 50.00 | 63.00 | 53.00 | 1.36 | BSS03M025 | 1 | 6 mm |
| BT40EM20063M | 1 | 20.00 | 52.00 | 63.00 | 55.00 | 1.40 | BSS03M026 | 1 | 8 mm |
| BT40EM25090M | 1 | 25.00 | 65.00 | 90.00 | 60.00 | 2.22 | BSS03M027 | 2 | 10 mm |
| BT40EM32110M | 1 | 32.00 | 72.00 | 110.00 | 65.00 | 2.50 | BSS03M029 | 2 | 10mm |
| BT40BEM06050M | 2 | 6.00 | 25.00 | 50.00 | 40.00 | 1.00 | BSS03M012 | 1 | 3 mm |
| BT40BEM08050M | 2 | 8.00 | 28.00 | 50.00 | 40.00 | 1.04 | BSS03M014 | 1 | 4 mm |
| BT40BEM10063M | 2 | 10.00 | 35.00 | 63.00 | 45.00 | 1.17 | BSS03M018 | 1 | 5 mm |
| BT40BEM12063M | 2 | 12.00 | 42.00 | 63.00 | 50.00 | 1.26 | BSS03M023 | 1 | 6 mm |
| BT40BEM14063M | 2 | 14.00 | 44.00 | 63.00 | 50.00 | 1.29 | BSS03M023 | 1 | 6 mm |
| BT40BEM16063M | 2 | 16.00 | 48.00 | 63.00 | 53.00 | 1.34 | BSS03M025 | 1 | 6 mm |
| BT40BEM18063M | 2 | 18.00 | 50.00 | 63.00 | 53.00 | 1.36 | BSS03M025 | 1 | 6 mm |
| BT40BEM20063M | 2 | 20.00 | 52.00 | 63.00 | 55.00 | 1.40 | BSS03M026 | 1 | 8 mm |
| BT40BEM25090M | 2 | 25.00 | 65.00 | 90.00 | 60.00 | 2.22 | BSS03M027 | 2 | 10 mm |
| BT40BEM32110M | 2 | 32.00 | 72.00 | 110.00 | 65.00 | 2.50 | BSS03M029 | 2 | 10mm |
| BT40EM025255 | 1 | 1/4 | 1.00 | 2.55 | 3.93 | 2.36 | BELS025025G | 1 | 1/8 |
| BT40EM031255 | 1 | 5/16 | 1.00 | 2.55 | 3.93 | 2.36 | BELS031031G | 1 | 5/32 |
| BT40EM038255 | 1 | 3/8 | 1.00 | 2.55 | 3.93 | 2.51 | BELS038031G | 1 | 3/16 |
| BT40EM050255 | 1 | 1/2 | 1.38 | 2.55 | 3.93 | 2.51 | BELS044038G | 1 | 7/32 |
| BT40EM050400 | 1 | 1/2 | 1.38 | 4.00 | 5.38 | 3.02 | BELS044038G | 1 | 7/32 |
| BT40EM062255 | 1 | 5/8 | 1.63 | 2.55 | 2.09 | 2.69 | BELS056050G | 1 | 1/4 |
| BT40EM075150 | 1 | 3/4 | 1.68 | 1.50 | 2.22 | 2.09 | BELS062050G | 1 | 5/16 |
| BT40EM075255 | 1 | 3/4 | 1.75 | 2.55 | 2.22 | 2.73 | BELS062050G | 1 | 5/16 |
| BT40EM088335 | 1 | 7/8 | 2.00 | 3.35 | 2.22 | 3.57 | BELS062050G | 1 | 5/16 |
| BT40EM100162 | 1 | 1 | 2.04 | 1.63 | 2.46 | 2.01 | BELS075044G | 2 | 3/8 |
| BT40EM100374 | 1 | 1 | 2.00 | 3.74 | 2.56 | 3.75 | BELS075056G | 2 | 3/8 |
| BT40EM100500 | 1 | 1 | 2.00 | 5.00 | 4.49 | 4.54 | BELS075056G | 2 | 3/8 |
| BT40EM125250 | 1 | 1 1/4 | 2.46 | 2.50 | 2.51 | 3.04 | BELS075062G | 2 | 3/8 |
| BT40EM125335 | 1 | 1 1/4 | 2.40 | 3.35 | 2.51 | 3.95 | BELS075056G | 2 | 3/8 |
| BT50EM06063M | 1 | 6.00 | 25.00 | 63.00 | 40.00 | 3.57 | BSS03M012 | 1 | 3 mm |
| BT50EM06150M | 1 | 6.00 | 25.00 | 150.00 | 40.00 | 3.57 | BSS03M012 | 1 | 3 mm |
| BT50EM08063M | 1 | 8.00 | 28.00 | 63.00 | 40.00 | 3.59 | BSS03M014 | 1 | 4 mm |
| BT50EM08150M | 1 | 8.00 | 28.00 | 150.00 | 40.00 | 3.82 | BSS03M014 | 1 | 4 mm |
| BT50EM10080M | 1 | 10.00 | 35.00 | 80.00 | 45.00 | 3.88 | BSS03M018 | 1 | 5 mm |

| | | | | | | | | | |
|---------------|---|-------|--------|--------|-------|-------|-------------|---|-------|
| BT50EM10100M | 1 | 10.00 | 35.00 | 100.00 | 45.00 | 3.88 | BSS03M018 | 1 | 5 mm |
| BT50EM12080M | 1 | 12.00 | 42.00 | 80.00 | 50.00 | 3.85 | BSS03M023 | 1 | 6 mm |
| BT50EM16080M | 1 | 16.00 | 48.00 | 80.00 | 53.00 | 3.96 | BSS03M025 | 1 | 6 mm |
| BT50EM20080M | 1 | 20.00 | 52.00 | 80.00 | 55.00 | 4.01 | BSS03M026 | 1 | 8 mm |
| BT50EM25105M | 1 | 25.00 | 65.00 | 105.00 | 60.00 | 4.88 | BSS03M027 | 2 | 10 mm |
| BT50EM32105M | 1 | 32.00 | 72.00 | 105.00 | 65.00 | 5.11 | BSS03M029 | 2 | 10 mm |
| BT50EM40120M | 1 | 40.00 | 90.00 | 120.00 | 75.00 | 6.66 | BSS03M029 | 2 | 10 mm |
| BT50EM50130M | 1 | 50.00 | 100.00 | 130.00 | 85.00 | 7.60 | BSS03M030 | 2 | 12 mm |
| BT50BEM06063M | 2 | 6.00 | 25.00 | 63.00 | 40.00 | 3.57 | BSS03M012 | 1 | 3 mm |
| BT50BEM06150M | 2 | 6.00 | 25.00 | 150.00 | 40.00 | 3.57 | BSS03M012 | 1 | 3 mm |
| BT50BEM08063M | 2 | 8.00 | 28.00 | 63.00 | 40.00 | 3.59 | BSS03M014 | 1 | 4 mm |
| BT50BEM08150M | 2 | 8.00 | 28.00 | 150.00 | 40.00 | 3.82 | BSS03M014 | 1 | 4 mm |
| BT50BEM10080M | 2 | 10.00 | 35.00 | 80.00 | 45.00 | 3.88 | BSS03M018 | 1 | 5 mm |
| BT50BEM10100M | 2 | 10.00 | 35.00 | 100.00 | 45.00 | 3.88 | BSS03M018 | 1 | 5 mm |
| BT50BEM12080M | 2 | 12.00 | 42.00 | 80.00 | 50.00 | 3.85 | BSS03M023 | 1 | 6 mm |
| BT50BEM16080M | 2 | 16.00 | 48.00 | 80.00 | 53.00 | 3.96 | BSS03M025 | 1 | 6 mm |
| BT50BEM20080M | 2 | 20.00 | 52.00 | 80.00 | 55.00 | 4.01 | BSS03M026 | 1 | 8 mm |
| BT50BEM25105M | 2 | 25.00 | 65.00 | 105.00 | 60.00 | 4.88 | BSS03M027 | 2 | 10 mm |
| BT50BEM32105M | 2 | 32.00 | 72.00 | 105.00 | 65.00 | 5.11 | BSS03M029 | 2 | 10 mm |
| BT50BEM40120M | 2 | 40.00 | 90.00 | 120.00 | 75.00 | 6.66 | BSS03M029 | 2 | 10 mm |
| BT50BEM50130M | 2 | 50.00 | 100.00 | 130.00 | 85.00 | 7.60 | BSS03M030 | 2 | 12 mm |
| BT50EM050295 | 1 | 1/2 | 1.38 | 2.95 | 1.97 | 8.14 | BELS044038G | 1 | 7/32 |
| BT50EM075295 | 1 | 3/4 | 1.75 | 2.95 | 2.22 | 8.36 | BELS062050G | 1 | 5/16 |
| BT50EM100413 | 1 | 1 | 2.00 | 4.13 | 2.46 | 9.30 | BELS075056G | 2 | 3/8 |
| BT50EM100600 | 1 | 1 | 2.00 | 6.00 | 2.46 | 10.54 | BELS075056G | 2 | 3/8 |
| BT50EM125413 | 1 | 1 1/4 | 2.50 | 4.13 | 2.51 | 10.23 | BELS075062G | 2 | 3/8 |
| BT50EM125600 | 1 | 1 1/4 | 2.50 | 6.00 | 2.51 | 12.54 | BELS075062G | 2 | 3/8 |
| BT50EM150413 | 1 | 1 1/2 | 2.75 | 4.13 | 2.93 | 10.41 | BELS075062G | 2 | 3/8 |
| BT50EM200531 | 1 | 2 | 3.75 | 5.31 | 3.37 | 16.00 | BELS100088G | 2 | 1/2 |

Dynamically Balanced at : G6.3@15,000 RPM
Order Example : BT50EM06063M
Dynamically balanced on Request
G2.5@20,000 RPM
Order Example : BT50EM06063MG2.5

Scope of Supply : Basic Tool Holder, Lockscrew
Accessories : To be ordered separately
Pull Stud : Page No.
All details are subject to change without Notice

END MILL HOLDERS

DIN 69893

TAPER ACCURACY
AT3

G VALUE
6.3

RPM
15000

COOLANT SYSTEM
AD

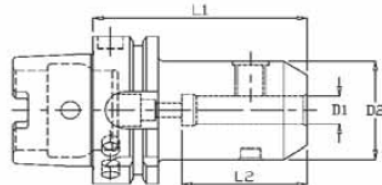

| Catalogue No | Fig | D1 | D2 | L1 | L2 | Wt.Kg | Clamping Screw | No of Clamp Scr | Wrench |
|----------------|-----|-------|-------|--------|-------|-------|----------------|-----------------|-----------|
| | | | | | | | | | Allen Key |
| HSK50AEM06065M | | 6.00 | 25.00 | 65.00 | 43.00 | 0.70 | BSS03M012 | 1 | 3mm |
| HSK50AEM08065M | | 8.00 | 28.00 | 65.00 | 40.00 | 0.80 | BSS03M014 | 1 | 4mm |
| HSK50AEM10065M | | 10.00 | 35.00 | 65.00 | 41.00 | 0.80 | BSS03M018 | 1 | 5mm |
| HSK50AEM12080M | | 12.00 | 42.00 | 80.00 | 50.00 | 1.20 | BSS03M023 | 1 | 6mm |
| HSK50AEM14080M | | 14.00 | 44.00 | 80.00 | 50.00 | 1.30 | BSS03M023 | 1 | 6mm |
| HSK50AEM16080M | | 16.00 | 48.00 | 80.00 | 53.00 | 1.30 | BSS03M025 | 1 | 6mm |
| HSK50AEM18080M | | 18.00 | 50.00 | 80.00 | 53.00 | 1.40 | BSS03M025 | 1 | 6mm |
| HSK50AEM20080M | | 20.00 | 52.00 | 80.00 | 55.00 | 1.50 | BSS03M026 | 1 | 8mm |
| HSK50AEM025300 | | ¼ | 1.00 | 3.00 | 1.70 | 1.08 | BELS025025G | 1 | 1/8 |
| HSK50AEM038300 | | 3/8 | 1.00 | 3.00 | 1.73 | 1.04 | BELS038031G | 1 | 3/16 |
| HSK50AEM050300 | | ½ | 1.38 | 3.00 | 1.97 | 1.32 | BELS044038G | 1 | 7/32 |
| HSK50AEM062375 | | 5/8 | 1.63 | 3.75 | 2.09 | 1.57 | BELS056050G | 1 | ¼ |
| HSK50AEM075375 | | ¾ | 1.75 | 3.75 | 2.22 | 2.09 | BELS062050G | 1 | 5/16 |
| HSK63AEM06065M | | 6.00 | 25.00 | 65.00 | 43.00 | 0.76 | BSS03M012 | 1 | 3mm |
| HSK63AEM08065M | | 8.00 | 28.00 | 65.00 | 40.00 | 0.79 | BSS03M014 | 1 | 4mm |
| HSK63AEM10065M | | 10.00 | 35.00 | 65.00 | 41.00 | 0.88 | BSS03M018 | 1 | 5mm |
| HSK63AEM12080M | | 12.00 | 42.00 | 80.00 | 50.00 | 1.13 | BSS03M023 | 1 | 6mm |
| HSK63AEM14080M | | 14.00 | 44.00 | 80.00 | 50.00 | 1.17 | BSS03M023 | 1 | 6mm |
| HSK63AEM16080M | | 16.00 | 48.00 | 80.00 | 53.00 | 1.26 | BSS03M025 | 1 | 6mm |
| HSK63AEM18080M | | 18.00 | 50.00 | 80.00 | 53.00 | 1.30 | BSS03M025 | 1 | 6mm |
| HSK63AEM20080M | | 20.00 | 52.00 | 80.00 | 55.00 | 1.33 | BSS03M026 | 1 | 8mm |
| HSK63AEM25110M | | 25.00 | 65.00 | 110.00 | 60.00 | 2.30 | BSS03M027 | 2 | 10mm |

| | | | | | | | | | |
|---|--|-------|--------|--------|-------|--|-------------|---|------|
| HSK63AEM32110M | | 32.00 | 72.00 | 110.00 | 65.00 | 2.52 | BSS03M029 | 2 | 10mm |
| HSK63AEM025300 | | ¼ | 1.00 | 3.00 | 2.14 | 1.79 | BELS025025G | 1 | 1/8 |
| HSK63AEM038300 | | 3/8 | 1.00 | 3.00 | 1.73 | 1.76 | BELS038031G | 1 | 3/16 |
| HSK63AEM050300 | | ½ | 1.38 | 3.00 | 1.97 | 2.05 | BELS044038G | 1 | 7/32 |
| HSK63AEM062375 | | 5/8 | 1.63 | 3.75 | 2.09 | 2.71 | BELS056050G | 1 | ¼ |
| HSK63AEM075375 | | ¾ | 1.75 | 3.75 | 2.22 | 2.85 | BELS062050G | 1 | 5/16 |
| HSK63AEM100375 | | 1 | 2.00 | 3.75 | 2.46 | 3.11 | BELS075056G | 1 | 3/8 |
| HSK63AEM125425 | | 1 ¼ | 2.50 | 4.25 | 2.51 | 4.51 | BELS075062G | 1 | 3/8 |
| HSK100AEM06080M | | 6.00 | 25.00 | 80.00 | 52.00 | 2.16 | BSS03M012 | 1 | 3mm |
| HSK100AEM08080M | | 8.00 | 28.00 | 80.00 | 52.00 | 2.19 | BSS03M014 | 1 | 4mm |
| HSK100AEM10080M | | 10.00 | 35.00 | 80.00 | 52.00 | 2.30 | BSS03M018 | 1 | 5mm |
| HSK100AEM12080M | | 12.00 | 42.00 | 80.00 | 49.00 | 2.44 | BSS03M023 | 1 | 6mm |
| HSK100AEM14080M | | 14.00 | 44.00 | 80.00 | 49.00 | 2.49 | BSS03M023 | 1 | 6mm |
| HSK100AEM16100M | | 16.00 | 48.00 | 100.00 | 53.00 | 2.83 | BSS03M025 | 1 | 6mm |
| HSK100AEM18100M | | 18.00 | 50.00 | 100.00 | 53.00 | 2.89 | BSS03M025 | 1 | 6mm |
| HSK100AEM20100M | | 20.00 | 52.00 | 100.00 | 55.00 | 2.94 | BSS03M026 | 1 | 8mm |
| HSK100AEM25100M | | 25.00 | 65.00 | 100.00 | 60.00 | 3.46 | BSS03M027 | 2 | 10mm |
| HSK100AEM32100M | | 32.00 | 72.00 | 100.00 | 65.00 | 3.71 | BSS03M029 | 2 | 10mm |
| HSK100AEM40120M | | 40.00 | 90.00 | 120.00 | 75.00 | 5.49 | SS03M032 | 2 | 10mm |
| HSK100AEM50130M | | 50.00 | 100.00 | 130.00 | 85.00 | 6.37 | | 2 | 12mm |
| HSK100AEM025300 | | ¼ | 1.00 | 3.00 | 1.89 | 4.77 | BELS025025G | 1 | 1/8 |
| HSK100AEM038300 | | 3/8 | 1.00 | 3.00 | 1.89 | 4.74 | BELS038031G | 1 | 3/16 |
| HSK100AEM050325 | | ½ | 1.38 | 3.25 | 1.97 | 5.06 | BELS044038G | 1 | 7/32 |
| HSK100AEM062375 | | 5/8 | 1.63 | 3.75 | 2.09 | 5.61 | BELS056050G | 1 | ¼ |
| HSK100AEM075375 | | ¾ | 1.75 | 3.75 | 2.22 | 5.75 | BELS062050G | 1 | 5/16 |
| HSK100AEM100425 | | 1 | 2.00 | 4.25 | 2.46 | 6.43 | BELS075056G | 2 | 3/8 |
| HSK100AEM125425 | | 1 ¼ | 2.50 | 4.25 | 2.51 | 7.63 | BELS075062G | 2 | 3/8 |
| HSK100AEM150450 | | 1 ½ | 2.75 | 4.50 | 2.93 | 8.35 | BELS075069G | 2 | 3/8 |
| HSK100AEM200550 | | 2 | 3.75 | 5.50 | 3.53 | 14.05 | BELS100088G | 2 | ½ |
| HSK100AEM250575 | | 2 ½ | 4.19 | 5.75 | 3.63 | 16.04 | BELS100088G | 2 | 1/2 |
| Dynamically Balanced at : G6.3@15,000 RPM Order Example : HSK100AEM025300 Dynamically balanced on Request G2.5@20,000 RPM Order Example : HSK100AEM025300G2.5 | | | | | | Scope of Supply : Basic Tool Holder, Lockscrew Accessories : To be ordered separately Pull Stud : Page No. All details are subject to change without Notice | | | |

| | | | | | |
|-------------------------|-----------|-----------------------|----------------|--------------|-----------------------------|
| END MILL HOLDERS | DIN 69871 | TAPER ACCURACY AT3 | G VALUE 6.3 | RPM 15000 | COOLANT SYSTEM AD , AD/B |
|-------------------------|-----------|-----------------------|----------------|--------------|-----------------------------|

FIG-1
Form A

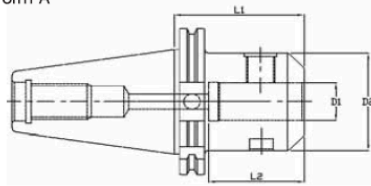
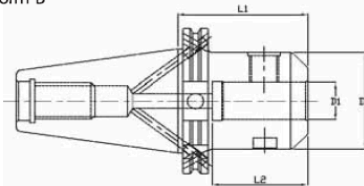

FIG-2
Form B



| Catalogue No | Fig | D1 | D2 | L1 | L2 | Wt.Kg | Clamping Screw | No of Clamp Scr | Wrench Allen Key |
|---------------|-----|-------|-------|--------|-------|-------|----------------|-----------------|------------------|
| DV40EM06050M | 1 | 6.00 | 25.00 | 50.00 | 40.00 | 0.90 | BSS03M012 | 1 | 3mm |
| DV40EM08050M | 1 | 8.00 | 28.00 | 50.00 | 40.00 | 0.90 | BSS03M014 | 1 | 4 mm |
| DV40EM10050M | 1 | 10.00 | 35.00 | 50.00 | 45.00 | 1.17 | BSS03M018 | 1 | 5 mm |
| DV40EM12050M | 1 | 12.00 | 42.00 | 50.00 | 50.00 | 1.26 | BSS03M023 | 1 | 6 mm |
| DV40EM14050M | 1 | 14.00 | 44.00 | 50.00 | 50.00 | 1.06 | BSS03M023 | 1 | 6 mm |
| DV40EM16063M | 1 | 16.00 | 48.00 | 63.00 | 53.00 | 1.34 | BSS03M025 | 1 | 6 mm |
| DV40EM18063M | 1 | 18.00 | 50.00 | 63.00 | 53.00 | 1.27 | BSS03M025 | 1 | 6 mm |
| DV40EM20063M | 1 | 20.00 | 50.00 | 63.00 | 55.00 | 1.40 | BSS03M026 | 1 | 8 mm |
| DV40EM25100M | 1 | 25.00 | 65.00 | 100.00 | 60.00 | 2.22 | BSS03M027 | 2 | 10 mm |
| DV40EM32100M | 1 | 32.00 | 72.00 | 100.00 | 65.00 | 2.50 | BSS03M029 | 2 | 10 mm |
| DV40BEM06050M | 2 | 6.00 | 25.00 | 50.00 | 40.00 | 0.90 | BSS03M012 | 1 | 3mm |
| DV40BEM08050M | 2 | 8.00 | 28.00 | 50.00 | 40.00 | 0.90 | BSS03M014 | 1 | 4 mm |
| DV40BEM10050M | 2 | 10.00 | 35.00 | 50.00 | 45.00 | 1.00 | BSS03M018 | 1 | 5 mm |
| DV40BEM12050M | 2 | 12.00 | 42.00 | 50.00 | 50.00 | 1.20 | BSS03M023 | 1 | 6 mm |
| DV40BEM14050M | 2 | 14.00 | 44.00 | 50.00 | 50.00 | 1.16 | BSS03M023 | 1 | 6 mm |
| DV40BEM16063M | 2 | 16.00 | 48.00 | 63.00 | 53.00 | 1.34 | BSS03M025 | 1 | 6 mm |
| DV40BEM18063M | 2 | 18.00 | 50.00 | 63.00 | 53.00 | 1.27 | BSS03M025 | 1 | 6 mm |

| | | | | | | | | | |
|---------------|---|-------|-------|--------|-------|------|-----------|---|-------|
| DV40BEM20063M | 2 | 20.00 | 50.00 | 63.00 | 55.00 | 1.40 | BSS03M026 | 1 | 8 mm |
| DV40BEM25100M | 2 | 25.00 | 65.00 | 100.00 | 60.00 | 2.28 | BSS03M027 | 2 | 10 mm |
| DV40BEM32100M | 2 | 32.00 | 72.00 | 100.00 | 65.00 | 2.50 | BSS03M029 | 2 | 10 mm |

| | | | | | | | | | |
|---------------|---|-------|--------|--------|-------|------|-----------|---|-------|
| DV50EM06063M | 1 | 6.00 | 25.00 | 63.00 | 40.00 | 2.70 | BSS03M012 | 1 | 3mm |
| DV50EM06150M | 1 | 6.00 | 25.00 | 150.00 | 40.00 | 2.90 | BSS03M012 | 1 | 3mm |
| DV50EM08063M | 1 | 8.00 | 28.00 | 63.00 | 40.00 | 2.70 | BSS03M014 | 1 | 4 mm |
| DV50EM08150M | 1 | 8.00 | 28.00 | 150.00 | 40.00 | 2.90 | BSS03M014 | 1 | 4 mm |
| DV50EM10063M | 1 | 10.00 | 35.00 | 63.00 | 45.00 | 2.80 | BSS03M018 | 1 | 5 mm |
| DV50EM10150M | 1 | 10.00 | 35.00 | 150.00 | 45.00 | 3.00 | BSS03M018 | 1 | 5 mm |
| DV50EM12063M | 1 | 12.00 | 42.00 | 63.00 | 50.00 | 2.90 | BSS03M023 | 1 | 6 mm |
| DV50EM12150M | 1 | 12.00 | 42.00 | 150.00 | 50.00 | 3.10 | BSS03M023 | 1 | 6 mm |
| DV50EM16063M | 1 | 16.00 | 48.00 | 63.00 | 53.00 | 3.00 | BSS03M025 | 1 | 6 mm |
| DV50EM16150M | 1 | 16.00 | 48.00 | 150.00 | 53.00 | 3.20 | BSS03M025 | 1 | 6 mm |
| DV50EM20063M | 1 | 20.00 | 52.00 | 63.00 | 55.00 | 3.10 | BSS03M026 | 1 | 8 mm |
| DV50EM20150M | 1 | 20.00 | 52.00 | 150.00 | 55.00 | 3.30 | BSS03M026 | 1 | 8 mm |
| DV50EM25080M | 1 | 25.00 | 65.00 | 80.00 | 60.00 | 3.80 | BSS03M027 | 2 | 10 mm |
| DV50EM32100M | 1 | 32.00 | 72.00 | 100.00 | 65.00 | 4.60 | BSS03M029 | 2 | 10 mm |
| DV50EM40110M | 1 | 40.00 | 90.00 | 110.00 | 75.00 | 5.00 | BWS2025M | 2 | 10 mm |
| DV50EM50120M | 1 | 50.00 | 100.00 | 120.00 | 85.00 | 5.50 | BWS24M | 2 | 12 mm |
| DV50BEM16063M | 2 | 16.00 | 48.00 | 63.00 | 53.00 | 3.00 | BSS03M025 | 1 | 6 mm |
| DV50BEM20063M | 2 | 20.00 | 52.00 | 63.00 | 55.00 | 3.10 | BSS03M026 | 1 | 8 mm |
| DV50BEM25080M | 2 | 25.00 | 65.00 | 80.00 | 60.00 | 3.80 | BSS03M027 | 2 | 10 mm |
| DV50BEM32100M | 2 | 32.00 | 72.00 | 100.00 | 65.00 | 4.60 | BSS03M029 | 2 | 10 mm |
| DV50BEM40110M | 2 | 40.00 | 90.00 | 110.00 | 75.00 | 5.00 | BWS2025M | 2 | 10 mm |
| DV50BEM50120M | 2 | 50.00 | 100.00 | 120.00 | 85.00 | 5.50 | BWS24M | 2 | 12 mm |

Dynamically Balanced at : G6.3@15,000 RPM
Order Example : DV50EM40110M
Dynamically balanced on Request
G2.5@20,000 RPM
Order Example : DV50EM40110MG2.5

Scope of Supply : Basic Tool Holder, Lockscrew
Accessories : To be ordered separately
Pull Stud : Page No.
All details are subject to change without Notice

END MILL HOLDERS

ANSI B5.5

TAPER ACCURACY
AT3

G VALUE
6.3

RPM
15000

COOLANT SYSTEM
AD , AD/B



FIG-1
Form A

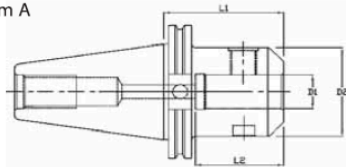
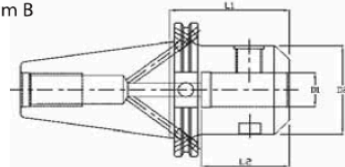

FIG-2
Form B



| Catalogue No | Fig | D1 | D2 | L1 | L2 | Wt.Kg | Clamping Screw | No of Clamp Scr | Wrench |
|---------------|-----|------|------|------|------|-------|----------------|-----------------|-----------|
| | | | | | | | | | Allen Key |
| CV40ZEM012138 | 1 | 1/8 | 0.69 | 1.38 | 2.89 | 1.79 | BS1045PKG | 1 | 3/32 |
| CV40EM012450 | 1 | 1/8 | 0.69 | 4.50 | 6.01 | 2.41 | BS1045PKG | 1 | 3/32 |
| CV40ZEM018138 | 1 | 3/16 | 0.69 | 1.38 | 2.89 | 1.79 | BS1045PKG | 1 | 3/32 |
| CV40EM018250 | 1 | 3/16 | 0.69 | 2.50 | 4.01 | 2.22 | BS1045PKG | 1 | 3/32 |
| CV40EM018450 | 1 | 3/16 | 0.69 | 4.50 | 6.01 | 2.41 | BS1045PKG | 1 | 3/32 |
| CV40ZEM025138 | 1 | 1/4 | 0.78 | 1.38 | 2.89 | 1.82 | BELS025025PKG | 1 | 1/8 |
| CV40EM025250 | 1 | 1/4 | 1.00 | 2.50 | 4.01 | 2.35 | BELS025025PKG | 1 | 1/8 |
| CV40EM025450 | 1 | 1/4 | 0.78 | 4.50 | 6.01 | 2.51 | BELS025025PKG | 1 | 1/8 |
| CV40ZEM031138 | 1 | 5/16 | 1.00 | 1.38 | 2.89 | 1.85 | BELS031031PKG | 1 | 5/32 |
| CV40EM031450 | 1 | 5/16 | 1.00 | 4.50 | 6.01 | 2.76 | BELS031031PKG | 1 | 5/32 |
| CV40ZEM038138 | 1 | 3/8 | 1.00 | 1.38 | 2.89 | 1.85 | BELS038031PKG | 1 | 3/16 |
| CV40EM038250 | 1 | 3/8 | 1.00 | 2.50 | 4.01 | 2.32 | BELS038031PKG | 1 | 3/16 |
| CV40EM038450 | 1 | 3/8 | 1.00 | 4.50 | 6.01 | 2.69 | BELS038031PKG | 1 | 3/16 |
| CV40EM038650 | 1 | 3/8 | 1.00 | 6.50 | 8.01 | 3.17 | BELS038031PKG | 1 | 3/16 |
| CV40ZEM044175 | 1 | 7/16 | 1.25 | 1.75 | 3.26 | 2.00 | BELS044038PKG | 1 | 7/32 |
| CV40EM044450 | 1 | 7/16 | 1.25 | 4.50 | 6.01 | 3.04 | BELS044038PKG | 1 | 7/32 |
| CV40ZEM050175 | 1 | 1/2 | 1.75 | 1.75 | 3.26 | 2.27 | BELS044038PKG | 1 | 7/32 |
| CV40EM050262 | 1 | 1/2 | 1.38 | 2.62 | 4.13 | 2.52 | BELS044038PKG | 1 | 7/32 |
| CV40EM050462 | 1 | 1/2 | 1.25 | 4.62 | 6.13 | 3.05 | BELS044038PKG | 1 | 7/32 |
| CV40EM050662 | 1 | 1/2 | 1.25 | 6.62 | 8.13 | 3.83 | BELS044038PKG | 1 | 7/32 |

| | | | | | | | | | |
|---------------|---|-------|------|-------|-------|-------|---------------|---|------|
| CV40ZEM062175 | 1 | 5/8 | 1.75 | 1.75 | 3.56 | 2.19 | BELS056050PKG | 1 | ¼ |
| CV40EM062375 | 1 | 5/8 | 1.50 | 3.75 | 3.56 | 2.96 | BELS056038PKG | 1 | ¼ |
| CV40EM062575 | 1 | 5/8 | 1.63 | 5.75 | 3.56 | 4.21 | BELS056050PKG | 1 | ¼ |
| CV40ZEM075175 | 1 | 3/4 | 1.75 | 1.75 | 2.40 | 2.09 | BELS062050PKG | 1 | 5/16 |
| CV40EM075375 | 1 | 3/4 | 1.75 | 3.75 | 3.94 | 3.21 | BELS062050PKG | 1 | 5/16 |
| CV40EM075575 | 1 | 3/4 | 1.75 | 5.75 | 3.94 | 4.44 | BELS062050PKG | 1 | 5/16 |
| CV40ZEM088175 | 1 | 7/8 | 1.88 | 1.75 | 2.27 | 2.31 | BELS062050PKG | 1 | 5/16 |
| CV40EM088400 | 1 | 7/8 | 2.00 | 4.00 | 4.19 | 3.65 | BELS062050PKG | 1 | 5/16 |
| CV40EM088600 | 1 | 7/8 | 1.88 | 6.00 | 4.19 | 4.86 | BELS062050PKG | 1 | 5/16 |
| CV40ZEM100175 | 1 | 1 | 1.75 | 1.75 | 2.64 | 1.78 | DWG ELS075044 | 2 | 3/8 |
| CV40EM100400 | 1 | 1 | 2.00 | 4.00 | 4.43 | 3.39 | BELS075056PKG | 2 | 3/8 |
| CV40EM100600 | 1 | 1 | 2.00 | 6.00 | 4.43 | 5.04 | BELS075056PKG | 2 | 3/8 |
| CV40ZEM125200 | 1 | 1 1/4 | 2.25 | 2.00 | 2.35 | 2.25 | BDWG | 2 | 3/8 |
| CV40EM125425 | 1 | 1 1/4 | 2.50 | 4.25 | 2.39 | 4.96 | BELS075062PKG | 2 | 3/8 |
| CV40EM125625 | 1 | 1 1/4 | 2.50 | 6.25 | 2.39 | 7.47 | BELS075062PKG | 2 | 3/8 |
| CV40EM150462 | 1 | 1 1/2 | 2.75 | 4.63 | 2.82 | 5.80 | BELS075069PKG | 2 | 3/8 |
| CV40EM150662 | 1 | 1 1/2 | 2.75 | 6.63 | 2.82 | 8.76 | BELS075069PKG | 2 | 3/8 |
| CV40BEM050262 | 2 | 1/2 | 1.38 | 2.62 | 4.13 | 2.48 | BELS044038PKG | 1 | 7/32 |
| CV40BEM062375 | 2 | 5/8 | 1.50 | 3.75 | 3.56 | 2.95 | BELS056050PKG | 1 | ¼ |
| CV40BEM075375 | 2 | 3/4 | 1.75 | 3.75 | 3.44 | 3.18 | BELS062050PKG | 1 | 5/16 |
| CV40BEM100400 | 2 | 1 | 2.00 | 4.00 | 4.43 | 3.37 | BELS075056PKG | 2 | 3/8 |
| CV40BEM125425 | 2 | 1 1/4 | 2.50 | 4.25 | 2.39 | 4.97 | BELS075062PKG | 2 | 3/8 |
| | | | | | | | | | |
| CV50EM018250 | 1 | 3/16 | 0.69 | 2.50 | 4.69 | 6.55 | BS1045PKG | 1 | 3/32 |
| CV50EM018450 | 1 | 3/16 | 0.69 | 4.50 | 6.69 | 6.84 | BS1045PKG | 1 | 3/32 |
| CV50EM018650 | 1 | 3/16 | 0.69 | 6.50 | 8.69 | 7.05 | BS1045PKG | 1 | 3/32 |
| CV50EM025250 | 1 | 1/4 | 0.78 | 2.50 | 4.69 | 6.55 | BELS025025PKG | 1 | 1/8 |
| CV50EM025450 | 1 | 1/4 | 0.78 | 4.50 | 6.69 | 7.17 | BELS025025PKG | 1 | 1/8 |
| CV50EM025650 | 1 | 1/4 | 0.78 | 6.50 | 7.68 | 7.19 | BELS025025PKG | 1 | 1/8 |
| CV50EM031250 | 1 | 5/16 | 1.00 | 2.50 | 4.69 | 6.61 | BELS031031PKG | 1 | 5/32 |
| CV50EM031450 | 1 | 5/16 | 1.00 | 4.50 | 6.69 | 7.15 | BELS031031PKG | 1 | 5/32 |
| CV50EM031650 | 1 | 5/16 | 1.00 | 6.50 | 8.69 | 7.60 | BELS031031PKG | 1 | 5/32 |
| CV50EM038250 | 1 | 3/8 | 1.00 | 2.50 | 4.69 | 6.63 | BELS038031PKG | 1 | 3/16 |
| CV50EM038450 | 1 | 3/8 | 1.00 | 4.50 | 6.69 | 7.07 | BELS038031PKG | 1 | 3/16 |
| CV50EM038650 | 1 | 3/8 | 1.00 | 6.50 | 8.69 | 7.45 | BELS038031PKG | 1 | 3/16 |
| CV50EM038850 | 1 | 3/8 | 1.00 | 8.50 | 10.70 | 8.27 | BELS038031PKG | 1 | 3/16 |
| CV50EM044250 | 1 | 7/16 | 1.25 | 2.50 | 4.69 | 6.78 | BELS044038PKG | 1 | 7/32 |
| CV50EM050262 | 1 | 1/2 | 1.38 | 2.62 | 4.81 | 6.82 | BELS044038PKG | 1 | 7/32 |
| CV50EM050462 | 1 | 1/2 | 1.38 | 4.62 | 6.81 | 7.52 | BELS044038PKG | 1 | 7/32 |
| CV50EM050662 | 1 | 1/2 | 1.38 | 6.62 | 8.81 | 8.21 | BELS044038PKG | 1 | 7/32 |
| CV50EM050850 | 1 | 1/2 | 1.25 | 8.50 | 10.70 | 9.03 | BELS044038PKG | 1 | 7/32 |
| CV50EM062375 | 1 | 5/8 | 1.63 | 3.75 | 5.94 | 7.53 | BELS056038PKG | 1 | ¼ |
| CV50EM062575 | 1 | 5/8 | 1.63 | 5.75 | 7.94 | 8.63 | BELS056050PKG | 1 | ¼ |
| CV50EM062775 | 1 | 5/8 | 1.63 | 7.75 | 9.94 | 9.48 | BELS056050PKG | 1 | ¼ |
| CV50EM075375 | 1 | 3/4 | 1.75 | 3.75 | 5.94 | 7.65 | BELS062050PKG | 1 | 5/16 |
| CV50EM075575 | 1 | 3/4 | 1.75 | 5.75 | 7.94 | 8.67 | BELS062050PKG | 1 | 5/16 |
| CV50EM075775 | 1 | 3/4 | 1.75 | 7.75 | 7.91 | 9.81 | BELS062050PKG | 1 | 5/16 |
| CV50EM0751000 | 1 | 3/4 | 1.75 | 10.00 | 12.20 | 12.25 | BELS062050PKG | 1 | 5/16 |
| CV50EM088375 | 1 | 7/8 | 2.00 | 3.75 | 4.19 | 7.65 | BELS062050PKG | 1 | 5/16 |
| CV50EM088575 | 1 | 7/8 | 2.00 | 5.75 | 4.19 | 9.44 | BELS062050PKG | 1 | 5/16 |
| CV50EM088775 | 1 | 7/8 | 2.00 | 7.75 | 4.19 | 10.85 | BELS062050PKG | 1 | 5/16 |
| CV50EM100400 | 1 | 1.00 | 2.00 | 4.00 | 4.43 | 7.95 | BELS075056PKG | 2 | 3/8 |
| CV50EM100600 | 1 | 1.00 | 2.00 | 6.00 | 4.43 | 9.39 | BELS075056PKG | 2 | 3/8 |
| CV50EM100800 | 1 | 1.00 | 2.00 | 8.00 | 4.43 | 10.80 | BELS075056PKG | 2 | 3/8 |
| CV50EM1001000 | 1 | 1.00 | 2.00 | 10.00 | 4.43 | 13.68 | BELS075056PKG | 2 | 3/8 |
| CV50EM125400 | 1 | 1 1/4 | 2.50 | 4.00 | 2.39 | 8.98 | BELS075062PKG | 2 | 3/8 |
| CV50EM125600 | 1 | 1 1/4 | 2.50 | 6.00 | 2.39 | 11.42 | BELS075062PKG | 2 | 3/8 |
| CV50EM125800 | 1 | 1 1/4 | 2.50 | 8.00 | 2.39 | 13.85 | BELS075062PKG | 2 | 3/8 |
| CV50EM1251000 | 1 | 1 1/4 | 2.50 | 10.00 | 2.39 | 16.28 | BELS075062PKG | 2 | 3/8 |
| CV50EM150400 | 1 | 1 1/2 | 2.75 | 4.00 | 2.82 | 9.19 | BELS075069PKG | 2 | 3/8 |
| CV50EM150600 | 1 | 1 1/2 | 2.75 | 6.00 | 2.82 | 12.21 | BELS075069PKG | 2 | 3/8 |
| CV50EM150800 | 1 | 1 1/2 | 2.75 | 8.00 | 2.82 | 15.25 | BELS075069PKG | 2 | 3/8 |
| CV50EM200562 | 1 | 2.00 | 3.75 | 5.62 | 3.38 | 15.96 | BELS100088PKG | 2 | ½ |
| CV50EM200762 | 1 | 2.00 | 3.75 | 7.62 | 3.38 | 19.01 | BELS100088PKG | 2 | ½ |
| CV50EM200962 | 1 | 2.00 | 3.75 | 9.62 | 3.38 | 22.08 | BELS100088PKG | 2 | ½ |
| CV50BEM050462 | 2 | 1/2 | 1.38 | 4.62 | 6.81 | 7.53 | BELS044038PKG | 1 | 7/32 |
| CV50BEM062375 | 2 | 5/8 | 1.62 | 3.75 | 5.94 | 7.47 | BELS056050PKG | 1 | ¼ |

| | | | | | | | | | |
|---|---|-------|------|------|------|--|---------------|---|------|
| CV50BEM075375 | 2 | 3/4 | 1.75 | 3.75 | 5.94 | 7.61 | BELS062050PKG | 1 | 5/16 |
| CV50BEM100400 | 2 | 1.00 | 2.00 | 4.00 | 3.07 | 7.91 | BELS075056PKG | 2 | 3/8 |
| CV50BEM125400 | 2 | 1 1/4 | 2.50 | 4.00 | 2.39 | 8.94 | BELS075062PKG | 2 | 3/8 |
| CV50BEM150400 | 2 | 1 1/2 | 2.75 | 4.00 | 2.82 | 9.15 | BELS075069PKG | 2 | 3/8 |
| Dynamically Balanced at : G6.3@15,000 RPM Order Example : CV50EM125800 Dynamically balanced on Request G2.5@20,000 RPM Order Example : CV50EM125800G2.5 | | | | | | Scope of Supply : Basic Tool Holder, Lockscrew Accessories : To be ordered seperately Pull Stud : Page No. All details are subject to change without Notice | | | |